

Threaded End Connection

Series S "9D" Nickel Aluminum Bronze

- 100% Made in USA
- To 1000 PSI WP
- 2" Through 4"
- ASTM B148 GR 955 "9D"
- Threaded Body Construction
- NACE Standard
 - Certified Low Emission Per API 641
 - Fire Safe Design
 - Enhanced Protection Against CO² and Saltwater Corrosion
 - Minimizes Risk of Galling Associated with Stainless Steel
 - Exceptional Yield Strength
 - Multi-Seal Seats (See page B-5)

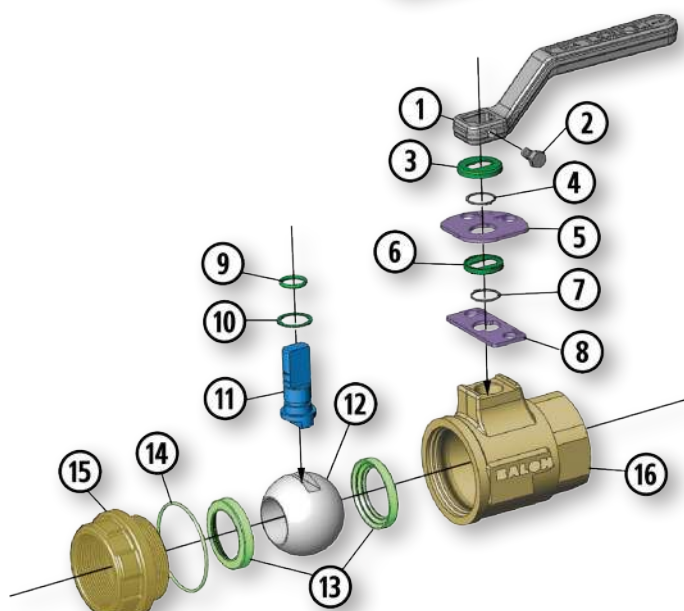

Material Description

ITEM	PART NAME	MATERIAL NACE (STANDARD)
1	Handle*	Carbon Steel/Ductile Iron
2	Handle Bolt	Standard Hex Bolt
3	Weather Guard	Polypropylene
4	Lock Plate Retainer	Stainless Steel
5	Lock Plate	Stainless Steel
6	Dust Cover	Polyethylene
7	Stop Plate Retainer	Stainless Steel
8	Stop Plate	Stainless Steel
9	Stem O-Ring	Fluorocarbon
10	Stem Seal	TFE
11	Stem	316 Stainless Steel
12	Ball	316 Stainless Steel
13	Ball Seat	Nylon 11 (TFE Optional**)
14	Body O-Ring	Fluorocarbon
15	End Adapter	ASTM B148-9D (955)
16	Body	ASTM B148-9D (955)

* Handle is optional. Balon valves can also be operated with a standard open-end wrench.

** Seat selection may result in de-rating of pressure. See Seat Pressure Ratings chart on page TD-4 for more information.

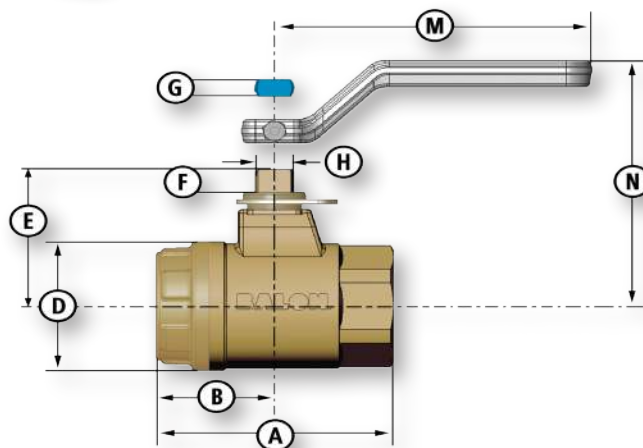

Dimensional Data

SIZE	CATALOG NUMBER	PORT	WP	A	B	D	E	F	G	H	M	N	LBS.	HANDLE	Cv
2x1.5x2	2R-S44N-SE	1.5	1000	5.25	2.66	3.38	3.66	0.75	.434	0.873	7.25	5.25	7.5	P-4128-CS	125
2x2x2	2F-S44N-SE	2.0	1000	5.75	2.88	4.25	4.38	0.75	.497	0.998	10.25	6.20	12	P-4129-CS	-
3x2x3	3R-S44N-SE	2.0	1000	7.25	3.50	4.50	4.38	0.75	.497	0.998	10.25	6.20	17	P-4129-CS	180
3x3x3	3F-S44N-SE	3.0	1000	8.75	4.38	6.00	5.75	0.88	.747	1.373	20.00	7.75	31	P-4127-DI	-
4x3x4	4R-S44N-SE	3.0	1000	8.75	4.38	6.00	5.75	0.88	.747	1.373	20.00	7.75	36	P-4127-DI	525
4x4x4	4F-S34N-SE	4.0	750	9.38	4.69	7.00	6.38	1.06	.747	1.373	20.00	8.38	52	P-4127-DI	-

Balon manufactured Actuation Mounting Hardware available. Please see page A-2 for details.

BALON

04.2024.Rev.1